

# Cahita Riviera

**IRM**  
IDÉALE RÉSIDENCE MOBILE

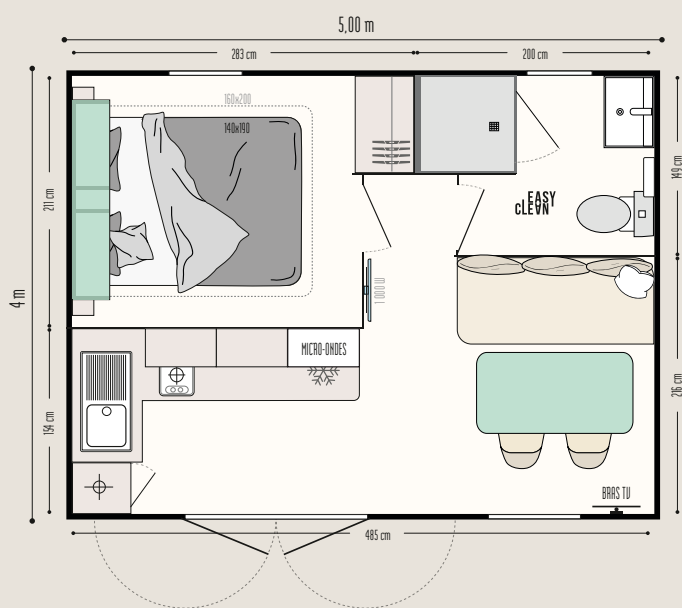

The duo model



## THE HIGHLIGHTS

- + Riviera-design summer kitchen with direct access to the terrace
- + Double-leaf door
- + Cosy lounge
- + Large bedroom with ample storage space

## The TOP options

Separating curtain allowing the living room to be turned into a second bedroom.  
160 x 200 cm bed in the bedroom.  
Extra bed in the living room.

17.80 m <sup>2</sup> *	Sleeps 2	5.00 x 4 m	1 bathroom	Terrace

## Cahita Riviera

# 1 BEDROOM

### MODUL'HOMES:

An entrance hall, relaxation area or storage space, modul'homes are perfectly suited to mobile homes with 1- and 2-slope roofs. They can be placed at the gable end or separately from the mobile home.



Modul'home for storage: bikes, surfboards, garden equipment, etc



Relaxation space



Extra room

The features, the layouts, you choose!



## The duo model

### KITCHEN

- Microwave cabinet
- Deep pan drawers
- White 2-ring gas hob
- 115 L tabletop refrigerator

### LIVING ROOM

- Dining table with round-edged top and angled metal legs
- 2 pendant lights above the table
- Sofa with feet
- 2 black inside/outside chairs
- TV mount
- Roller blind

### BEDROOM

- Open storage above the headboard
- Headboard fitted with adjustable reading lights with built-in switch
- 2 bedside tables
- Hotel-style wardrobe with drawer
- 18-slat bed base with raised legs and 35 kg/m<sup>3</sup> high-resistance foam mattress
- Blackout curtain

### BATHROOM & TOILET

- Easy Clean bathroom - easy to clean and designed to last
- 80 x 80 cm soft-touch shower tray with extra-flat threshold and high door with safety glass
- Frosted window for greater privacy
- Wall-mounted vanity unit with built-in towel rail
- Wall light
- Storage shelves
- Dual flush toilet (3/6 litres) and reinforced soundproofing

### STANDARD EQUIPMENT

- Smoke detector with 10-year warranty
- 100% LED lighting
- 1000 W smart electronic convector with digital display
- 35 kg/m<sup>3</sup> high-resistance, OEKO-TEX-certified foam mattress
- High and low vents
- Phthalate-free linoleum
- Central circuit breaker
- Aerial socket and TV cabling
- Large capacity kitchen wall units
- Kitchen base units on feet with PVC plinths
- Flow reducers on sink and washbasin mixer taps (7 l/min)
- Top-of-the-range, ACS-certified mixer taps
- Hydropower natural-draught gas water heater
- Environmental awareness sticker

