

Key West 1 Bedroom

CAPACITY: Sleeps 2

FLOOR AREA: 20.9 m²
(usable interior floor area) calculated according to the UNIVDL definition

DIMENSIONS: 5.53 x 4.45 m
(overall)



A high-end cocoon for nature lovers who want the very best in comfort. A true off-season asset to breathe new life into your accommodation offering, the 1-bed Key West transforms into a luxury annexe in the summer. Coupled with the 2- or 3-bed Key West, it is ideal for guests or for grown-up children.

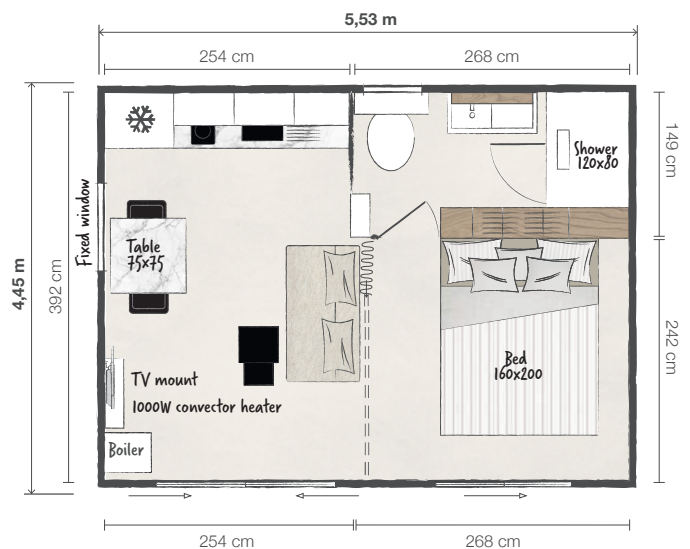

1-bed Key West standard equipment

OUTSIDE:

Horizontally fitted Muscade or Dune wood-effect Wild cladding

White doors and windows: sliding double doors at the front. Full-length fixed gable-end window in the living area.

White ornamental columns, guttering, downpipes and roofing sheets

Lighting: 1 LED outdoor bulkhead lights

Outdoor power socket

LIVING AREA:

Lounge/dining area:

75x75 cm square dining table with 2 chairs

Greige sofa

Pair of coffee tables

1,000W intelligent convector topped by a shelf unit with socket

Full-height enclosed service unit containing a 50-litre electric boiler

Ivory curtain and white sea foam net curtain

TV mount

Kitchen area:

Large capacity wall units. Base units with push-to-open door system

Resin sink with draining board integrated into the work surface

Top-of-the-range, ACS-certified mixer taps

2-ring gas-glass hob

Built-in extractor hood

Built-in 179 L fridge-freezer

MASTER SUITE:

160x200 cm bed with a total of over 90 cm of space to the sides

Headboard with built-in storage, bedside tables, reading lights and sockets

Bedroom separated from living area by hotel-style ivory curtain

Extra large 120x80 cm shower with extra-flat tray and His & Hers shower column

90 cm wide vanity unit with built-in storage and towel rails



Kitchen with optional 2-rings induction hob and integrated microwave



Shelf with round mirror above
Suspended dual flush WC

Design the Key West to suit your camp site with the help of your sales advisor's configurator program, view your plot directly.

Find the KeyWest video on



The options:

Bronze wood cladding, Wild Dune and Muscade cladding, fitted vertically

Wild Grizzli, Griscocéros and Châtaigne cladding fitted vertically or horizontally

Anthracite doors and windows, ornamental columns, roofing sheets, guttering and

downpipes
Built-in microwave
Bultex mattress
Induction hob
Hairdryer
Heated towel rail
USB socket

Mechanically-controlled ventilation
TV mount in the master bedroom

