

# Super Mercure

**IRM**  
IDÉALE RÉSIDENCE MOBILE

IDEAL

Everything  
you'd expect  
from the  
best-seller

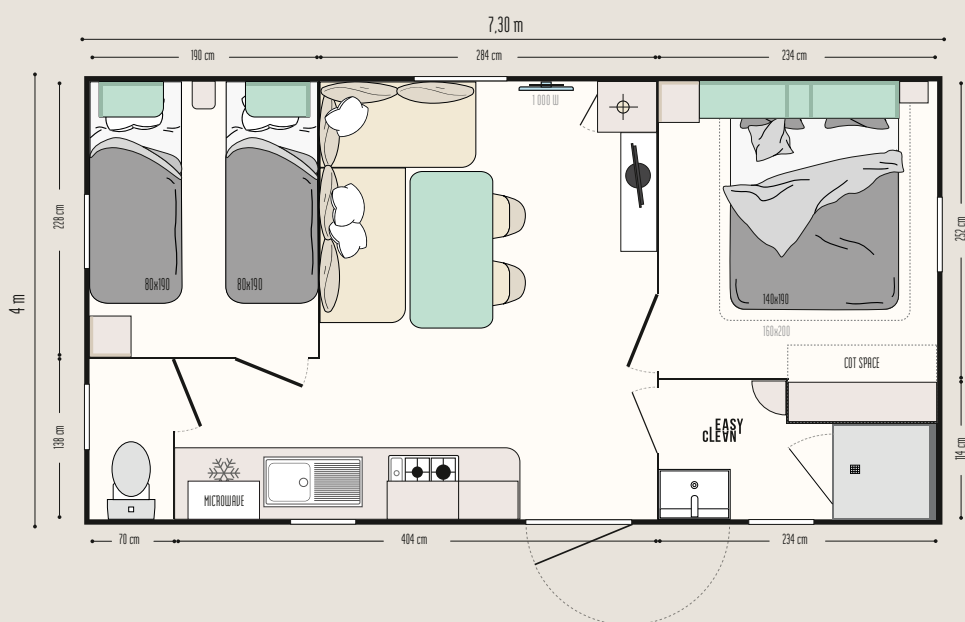

## THE HIGHLIGHTS

- + The most essential 26 m<sup>2</sup> on the market
- + Cosy living room oriented towards its TV cabinet
- + 160 x 200 cm bed compatible with a cot

## The TOP options

160 x 200 cm bed in the master bedroom without reducing freedom of movement.  
High transverse bed for more space or more beds.  
Sofa bed to accommodate 2 more people.



26.10 m<sup>2</sup>\*



Sleeps 4



7.30 x 4 m



1 bathroom

**New MODUL'HOMES:**  
the features, the layouts,  
you choose!



Separate room



Relaxation area



Bike rack and/or storage



An entrance hall, relaxation area or storage space, modul'homes are perfectly suited to mobile homes with 1- and 2-slope roofs. They can be placed at the gable end, as an entrance, or separately from the mobile home.



## The model that offers perfection

### KITCHEN

- Microwave cabinet
- Deep pan drawers
- White 4-ring gas hob
- 115 L tabletop refrigerator
- Roller blind

### LIVING ROOM

- Dining table with round-edged top and angled metal legs
- 2 pendant lights above the table
- Corner sofa with feet
- 2 black inside/outside chairs
- TV unit with storage
- Roller blind

### MASTER BEDROOM WITH SPACE FOR A COT

- Open storage cabinet above the headboard with integrated wardrobe
- Headboard fitted with adjustable reading lights with built-in switch
- 2 bedside tables
- Wall-mounted storage unit with wardrobe at the foot of the bed
- 18-slat bed base with raised legs and 35 kg/m<sup>3</sup> high-resistance foam mattress
- Blackout curtain

### CHILDREN'S/GUEST BEDROOM

- Open storage above the headboard
- Bedside table
- Wall-mounted storage unit at the foot of the bed
- 18-slat bed base with raised legs and 35 kg/m<sup>3</sup> high-resistance foam mattress
- Blackout curtain

### BATHROOM & TOILET

- Easy Clean bathroom - easy to clean and designed to last.
- 80 x 80 cm soft-touch shower tray with extra-flat threshold and high door with safety glass
- Frosted window for greater privacy
- Wall-mounted vanity unit with built-in towel rail
- Wall light
- Storage shelves
- Dual flush toilet (3/6 litres) and reinforced soundproofing

### STANDARD EQUIPMENT

- Smoke detector with 10-year warranty
- 100% LED lighting
- 1000 W smart electronic convector with digital display
- 35 kg/m<sup>3</sup> high-resistance, OEKO-TEX-certified foam mattress
- High and low vents
- Phthalate-free linoleum
- Central circuit breaker
- Aerial socket and TV cabling
- Large capacity kitchen wall units
- Kitchen base units on feet with PVC plinths
- Flow reducers on sink and washbasin mixer taps (7 l/min)
- Top-of-the-range, ACS-certified mixer taps
- Hydropower natural-draught gas water heater
- Environmental awareness sticker