

Cahita Riviera

IRM
IDÉALE RÉSIDENCE MOBILE

THE COCOON

Couples
love them

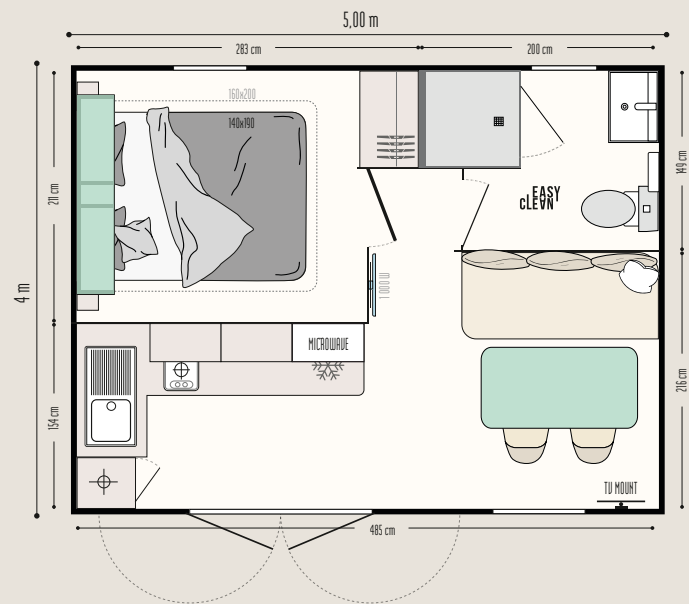

THE HIGHLIGHTS

- + Riviera-design summer kitchen with direct access to the terrace
- + Double-leaf door
- + Cosy lounge
- + Large bedroom with ample storage space

The TOP options

Separating curtain allowing the living room to be turned into a second bedroom.
160 x 200 cm bed in the bedroom.
Extra bed in the living room.



17.80 m²*



Sleeps 2



5.00 x 4 m



1 bathroom

Cahita Riviera

1 BEDROOM

New MODUL'HOMES:
the features, the layouts,
you choose!



Separate room



Relaxation area



Bike rack and/or storage



An entrance hall, relaxation area or storage space, modul'homes are perfectly suited to mobile homes with 1- and 2-slope roofs. They can be placed at the gable end, as an entrance, or separately from the mobile home.



The duo model

KITCHEN

- Microwave cabinet
- Deep pan drawers
- White 2-ring gas hob
- 115 L tabletop refrigerator

LIVING ROOM

- Dining table with round-edged top and angled metal legs
- 2 pendant lights above the table
- Sofa with feet
- 2 black inside/outside chairs
- TV mount
- Roller blind

BEDROOM

- Open storage above the headboard
- Headboard fitted with adjustable reading lights with built-in switch
- 2 bedside tables
- Hotel-style wardrobe with drawer
- 18-slat bed base with raised legs and 35 kg/m³ high-resistance foam mattress
- Blackout curtain

BATHROOM & TOILET

- Easy Clean bathroom - easy to clean and designed to last.
- 80 x 80 cm soft-touch shower tray with extra-flat threshold and high door with safety glass
- Frosted window for greater privacy
- Wall-mounted vanity unit with built-in towel rail
- Wall light
- Storage shelves
- Dual flush toilet (3/6 litres) and reinforced soundproofing

STANDARD EQUIPMENT

- Smoke detector with 10-year warranty
- 100% LED lighting
- 1000 W smart electronic convector with digital display
- 35 kg/m³ high-resistance, OEKO-TEX-certified foam mattress
- High and low vents
- Phthalate-free linoleum
- Central circuit breaker
- Aerial socket and TV cabling
- Large capacity kitchen wall units
- Kitchen base units on feet with PVC plinths
- Flow reducers on sink and washbasin mixer taps (7 l/min)
- Top-of-the-range, ACS-certified mixer taps
- Hydropower natural-draught gas water heater
- Environmental awareness sticker