

Super Cordélia

IRM
IDÉALE RÉSIDENCE MOBILE

SPACIOUS

An unrivalled
layout

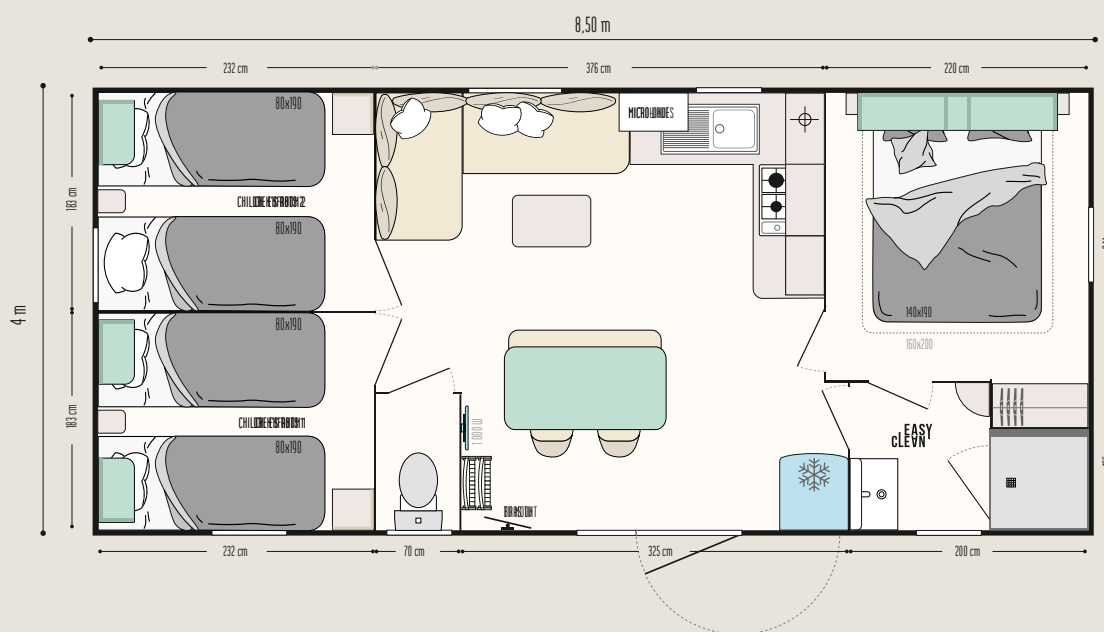

THE HIGHLIGHTS

- + Impressive living-room space
- + Separate living room, lounge and kitchen areas
- + Access to the bathroom from the master suite

The TOP options

Combination blackout blind and mosquito screen.

Sofa bed providing additional sleeping space for 2 people.

160 x 200 cm bed in the master bedroom without reducing freedom of movement.



30.50 m²*



Sleeps 6



8.50 x 4 m



1 bathroom

Super Cordélia

3 BEDROOMS

New MODUL'HOMES:
the features, the layouts,
you choose!



Separate room



Relaxation area



Bike rack and/or storage



An entrance hall, relaxation area or storage space, modul'homes are perfectly suited to mobile homes with 1- and 2-slope roofs. They can be placed at the gable end, as an entrance, or separately from the mobile home.



The family model

KITCHEN

- Microwave cabinet
- Deep pan drawers
- White 4-ring gas hob
- Fridge-freezer, 2 doors, 204 litres, white
- Roller blind

OPEN-PLAN LIVING AREA AND LOUNGE

- Dining table with round-edged top and angled metal legs
- 2 pendant lights above the table
- 2 black inside/outside chairs and 1 bench with metal legs
- 2 folding chairs
- TV mount
- Coffee table
- Corner sofa with feet
- Roller blind
- Mirror

MASTER BEDROOM WITH BATHROOM ACCESS

- Open storage cabinet above the headboard
- Headboard fitted with adjustable reading lights with built-in switch
- 2 bedside tables
- Hotel-style wardrobe with drawer
- 18-slat bed base with raised legs and 35 kg/m³ high-resistance foam mattress
- Blackout curtain

CHILDREN'S/GUEST BEDROOMS

- Open storage above the headboard
- Bedside table
- Wall-mounted storage unit at the foot of the bed
- 18-slat bed base with raised legs and 35 kg/m³ high-resistance foam mattress
- Blackout curtain

BATHROOM & TOILET

- Easy Clean bathroom - easy to clean and designed to last
- 80 x 80 cm soft-touch shower tray with extra-flat threshold and high door with safety glass
- Frosted window for greater privacy
- Wall-mounted vanity unit with built-in towel rail
- Wall light
- Storage shelves
- Dual flush toilet (3/6 litres) and reinforced soundproofing

STANDARD EQUIPMENT

- Smoke detector with 10-year warranty
- 100% LED lighting
- 1000 W smart electronic convector with digital display
- 35 kg/m³ high-resistance, OEKO-TEX-certified foam mattress
- High and low vents
- Phthalate-free linoleum
- Central circuit breaker
- Aerial socket and TV cabling
- Large capacity kitchen wall units
- Kitchen base units on feet with PVC plinths
- Flow reducers on sink and washbasin mixer taps (7 l/min)
- Top-of-the-range, ACS-certified mixer taps
- Hydropower natural-draught gas water heater
- Environmental awareness sticker